

AL-KO OVERRUN DEVICE

V 251S AND 251G – NEW GENERATION

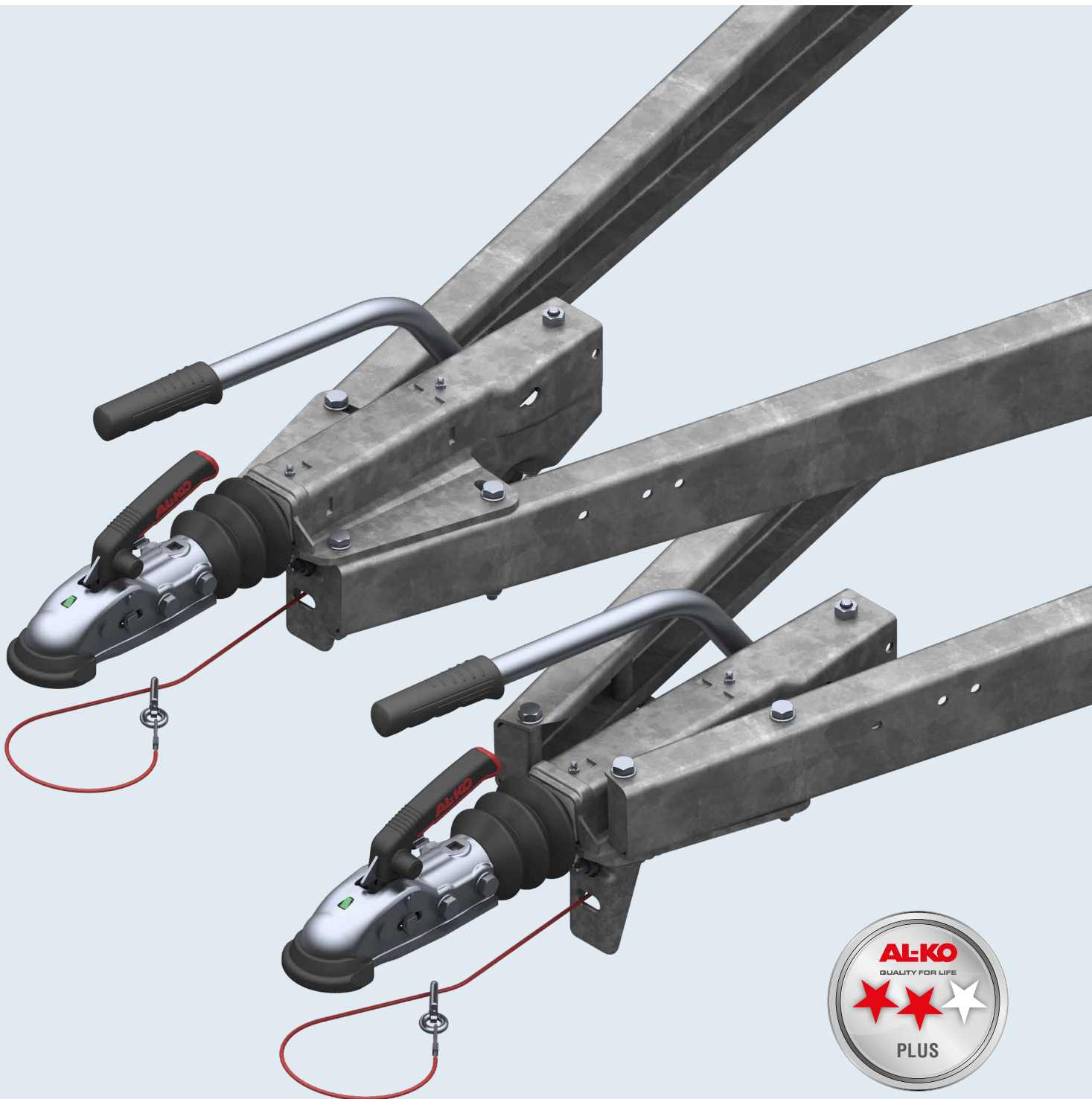

OVERRUN DEVICE V

1,500 to 3,000 kg

§ Existing trailer registrations are unaffected. AL-KO have been able to make the improvements through updates to the existing reports.

Mounting on the chassis

The drawbar struts can be installed at the top and bottom.

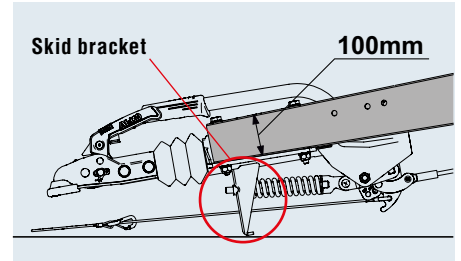
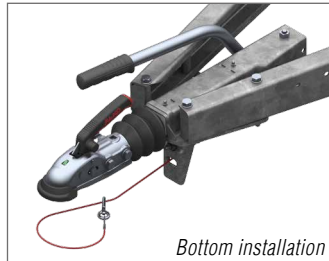

A cable guide is integrated in the skid bracket as standard so that the breakaway cable can activate the handbrake lever in an emergency.

In bottom installation, the maximum permissible drawbar height is 100 mm. The skid bracket integrated in the housing of the drawbar installation prevents any contact of the handbrake lever and the hitch/drawbar eye in an emergency.

Relay lever

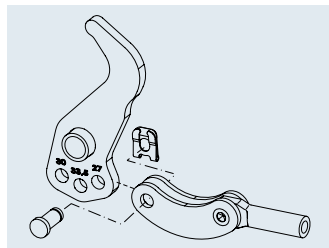
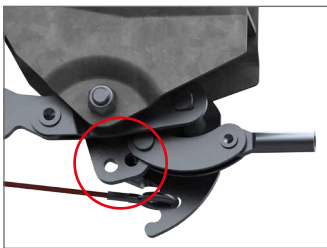

The relay lever can be simply changed over through existing holes as necessary.

- | 90:27 = 1636G, 1637, 2051
- | 90:30 = 2361
- | 90:33.5 = 3062, 3081

Bellows

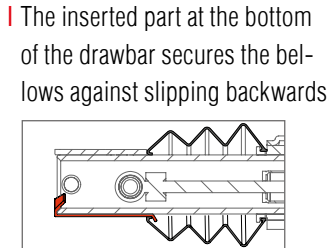
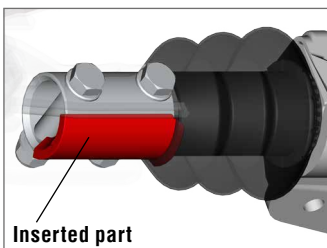

The inserted part at the bottom of the drawbar secures the bellows against slipping backwards.

The bellows are suitable for all ball couplings or drawbar eyes that can be used on this new overrun device.

Drawbar tube bearing

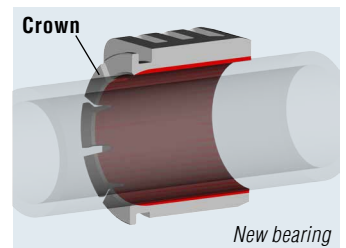
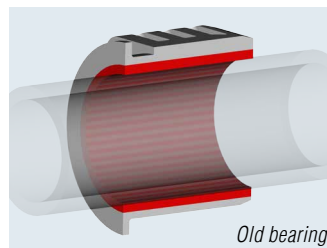

The optimised bearing bush geometry (crown in the front bearing bush with preload) and the modified machining process made it possible to reduce the bearing clearance.

Optional ball couplings and plug-in drawbar eyes can be used (installed externally on the drawbar tube)

With the **AE 251S** 1,500–2,700 kg, all drawbar eyes can be used for the Ø50 mm drawbar.



With the **AE 251G** 1,550–3,000 kg, no plug-in drawbar eyes (installed externally on the drawbar tube) can be used. We recommend using the "Profi" 3,000 kg overrun device here as necessary.



Parking brake/handbrake

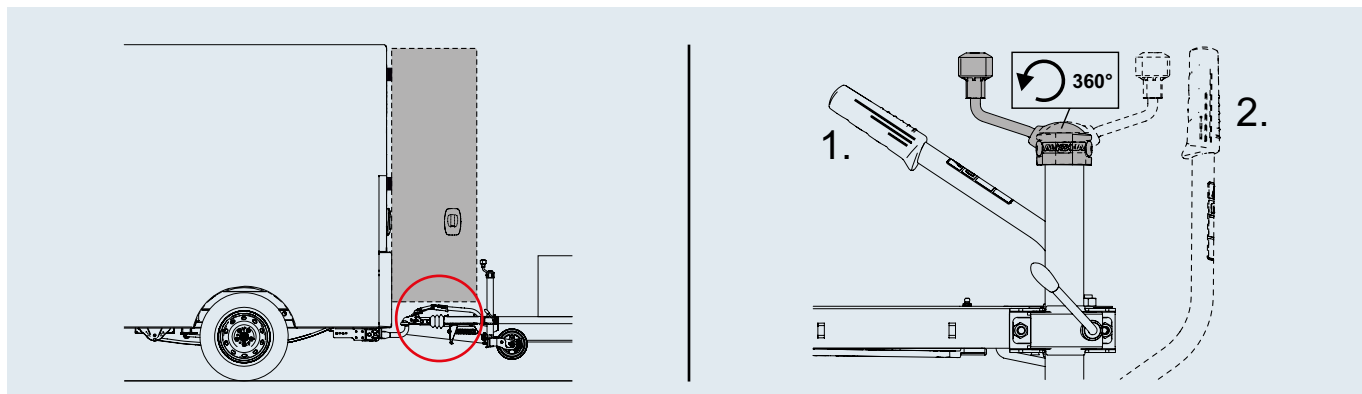

Handbrake not active:

In this position, the handbrake lever is very flat. For cars and vans, the loading door can usually be opened as a result.

Handbrake active:

Despite the active handbrake, the jockey wheel crank can be moved freely.

1. Handbrake down
2. Handbrake up

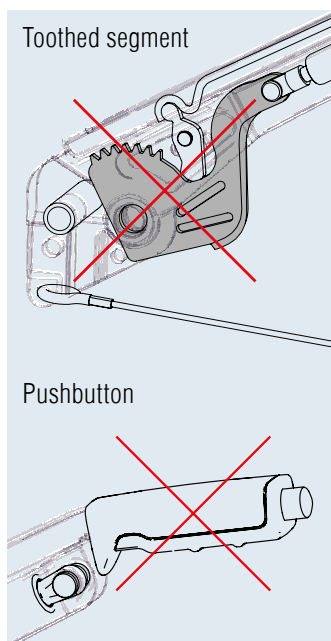

- | Sturdy tubular handbrake lever, galvanised.
- | The flat arrangement allows the operator to place his body weight over the hand lever when releasing the handbrake.

- | Ergonomic, extended hand grip with soft surface.

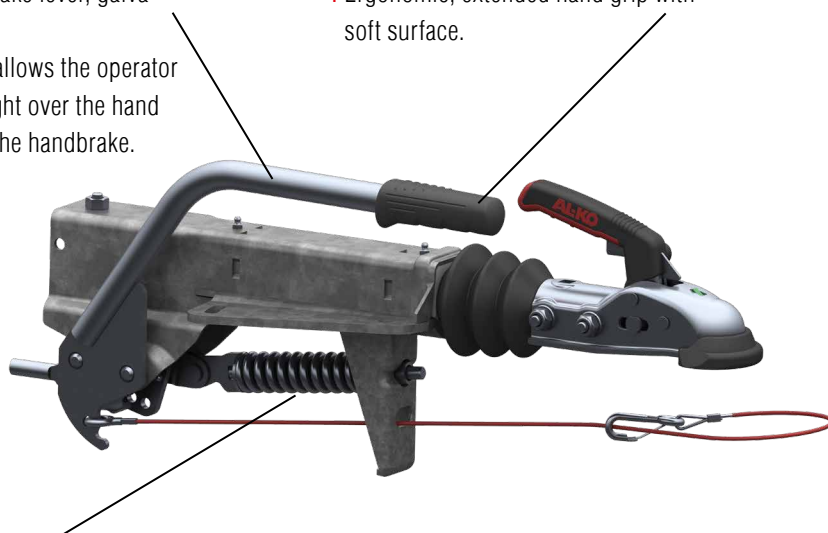

The pressure sprung dead-point mechanism eliminates the need for a toothed segment and push-button. This enables sensitive adjustment when coupling the trailer, e.g. on downhill gradients.

As standard with mounting holes for the Ø 48 mm clamp

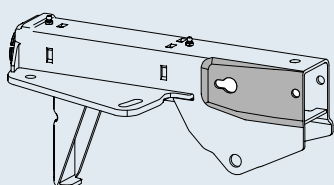

Optionally with welded-on bottom part of the clamp for Ø 48 mm jockey wheel

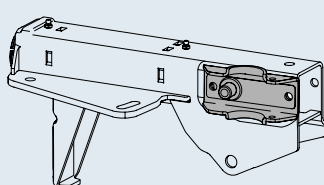

Optionally with welded-on jockey wheel centre flange

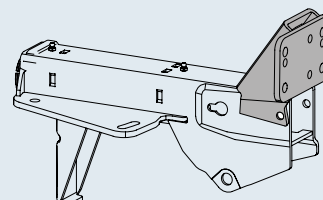

OVERRUN DEVICE V

1,500 to 2,700 kg



SAP: AE KPL V 251S TOTP AK270

Available starting May 2018

AE V 251S dead centre HBH with AK 270, without clamp

Order no.	Type	Total weight in kg	Support load in kg	Installation	Changeover relay lever?	Can be used with AL-KO wheel brake	Hitch mounted				
1 731 104	251 S	1,500 – 2,700	120	top + bottom	Yes	1637/2051	AK 270	13	–	24	2
1 731 336	251 S	1,500 – 2,700	120	top + bottom	yes	2361	AK 270	13	–	24	20
1 731 337	251 S	1,500 – 2,700	120	top + bottom	Yes	3062/3081	AK 270	13	–	24	20

ECE test report no.

Overrun device: 361-0044-97

ECE type approval no.

Drawbar installation: E1 55R-01 0227

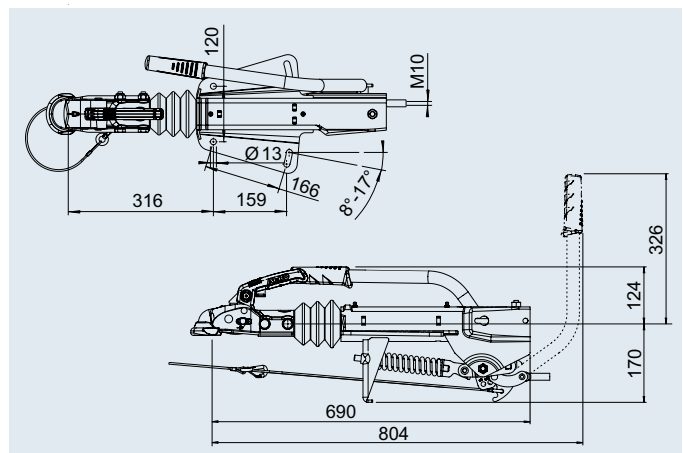

SAP: AE KPL V 251S TOTP AK270

Available starting May 2018

AE V 251S dead centre HBH with AK 270, with bottom part of the clamp

Order no.	Type	Total weight in kg	Support load in kg	Installation	Changeover relay lever?	Can be used with AL-KO wheel brake	Hitch mounted				
1 731 762	251 S	1,500 – 2,700	120	top + bottom	Yes	1637/2051	AK 270	13	–	21	20
1 731 763	251 S	1,500 – 2,700	120	top + bottom	Yes	2361	AK 270	13	–	21	20
1 731 764	251 S	1,500 – 2,700	120	top + bottom	Yes	3062/3081	AK 270	13	–	21	20

ECE test report no.

Overrun device: 361-0044-97

ECE type approval no.

Drawbar installation: E1 55R-01 0227

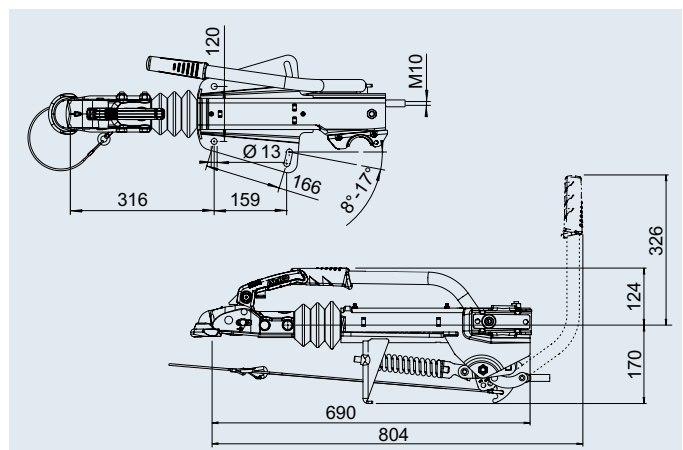

OVERRUN DEVICE V

1,500 to 2,700 kg



SAP: AE KPL V 251S TOTP AK270

Available starting August 2018

AE V 251S dead centre HBH with AK 270, with elevated jockey wheel flange

Order no.	Type	Total weight in kg	Support load in kg	Installation	Changeover relay lever?	Can be used with AL-KO wheel brake	Hitch mounted				
1 731 720	251 S	1,500 – 2,700	120	top + bottom	Yes	1637/2051	AK 270	18	–	19	2
1 731 721	251 S	1,500 – 2,700	120	top + bottom	Yes	2361	AK 270	18	–	19	20
1 731 722	251 S	1,500 – 2,700	120	top + bottom	Yes	3062/3081	AK 270	18	–	19	20

ECE test report no.

Overrun device: 361-0044-97

ECE type approval no.

Drawbar installation: E1 55R-01 0227

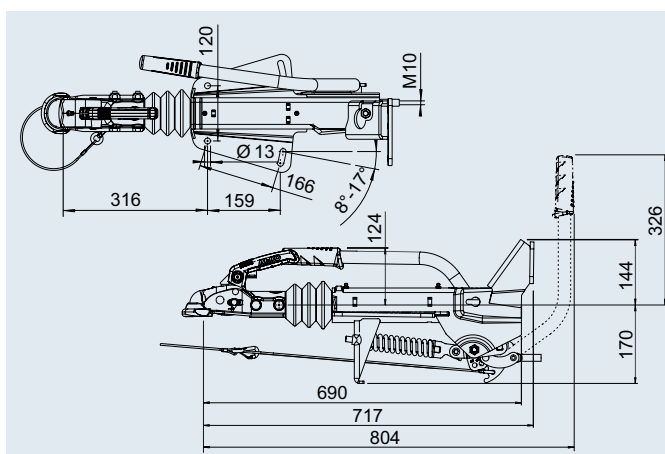

SAP: AE KPL V 251S TOTP

Available starting August 2018

AE V 251S dead centre HBH without coupling head, with elevated jockey wheel flange

Order no.	Type	Total weight in kg	Support load in kg	Installation	Changeover relay lever?	Can be used with AL-KO wheel brake	Hitch mounted				
1 731 724	251 S	1,500 – 2,700	120	top + bottom	Yes	1637/2051	without	16	–	19	2
1 731 725	251 S	1,500 – 2,700	120	top + bottom	Yes	2361	without	16	–	19	20
1 731 726	251 S	1,500 – 2,700	120	top + bottom	Yes	3062/3081	without	16	–	19	20

ECE test report no.

Overrun device: 361-0044-97

ECE type approval no.

Drawbar installation: E1 55R-01 0227

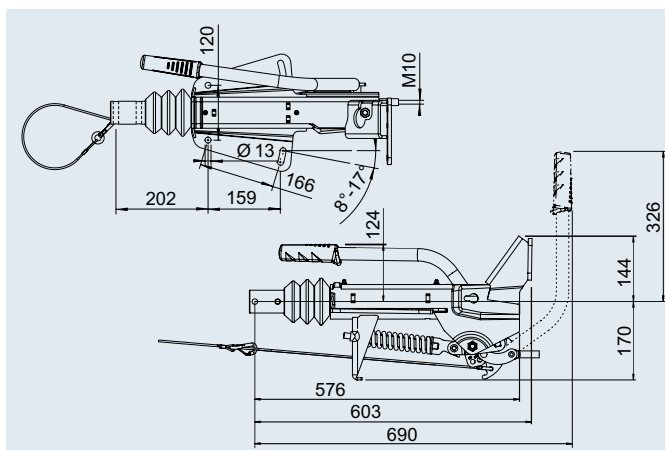
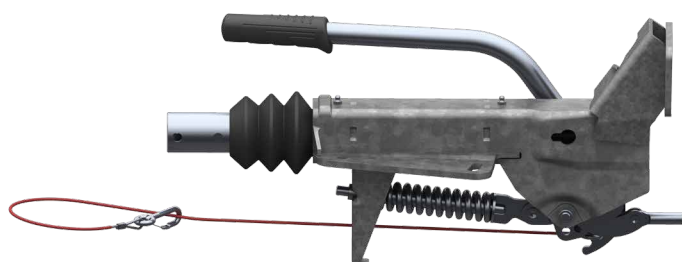

OVERRUN DEVICE V

1,550 to 3,000 kg



SAP: AE KPL V 251G TOTP AK301

Available starting August 2018

AE V 251G dead centre HBH with AK 301, without clamp

Order no.	Type	Total weight in kg	Support load in kg	Installation	Changeover relay lever?	Can be used with AL-KO wheel brake	Hitch mounted				
1 731 344	251 G	1,550 – 3,000	120	top + bottom	yes	1637/2051	AK 301	14	–	24	2
1 731 727	251 G	1,550 – 3,000	120	top + bottom	yes	2361	AK 301	14	–	24	20
1 731 728	251 G	1,550 – 3,000	120	top + bottom	yes	3062/3081	AK 301	14	–	24	20

ECE test report no.

Overrun device: 361-0043-97

ECE type approval no.

Drawbar installation: E1 55R-01 0466

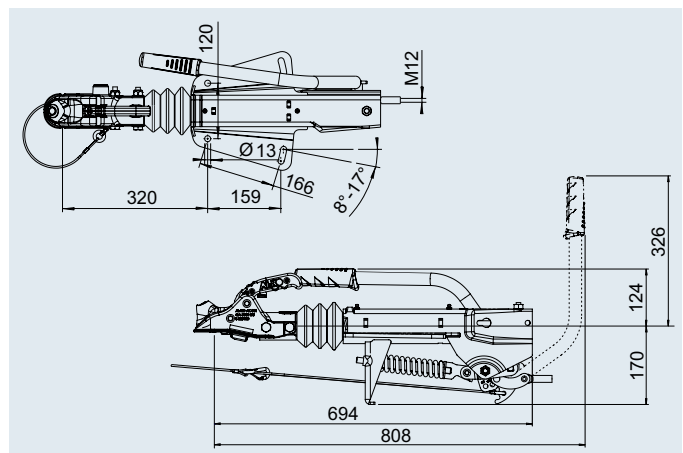
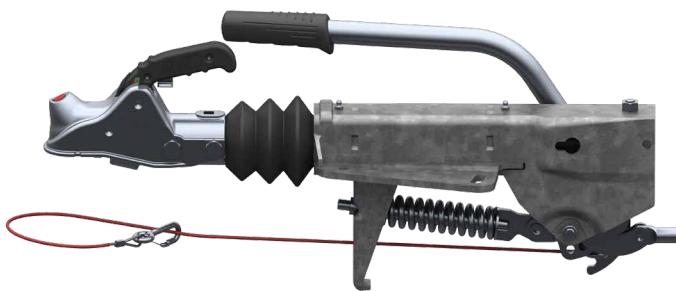

SAP: AE KPL V 251G TOTP AK301

Available starting August 2018

AE V 251G dead centre HBH with AK 301, with bottom part of the clamp

Order no.	Type	Total weight in kg	Support load in kg	Installation	Changeover relay lever?	Can be used with AL-KO wheel brake	Hitch mounted				
1 731 768	251 G	1,550 – 3,000	120	top + bottom	yes	1637/2051	AK 301	14	–	21	20
1 731 769	251 G	1,550 – 3,000	120	top + bottom	yes	2361	AK 301	14	–	21	20
1 731 770	251 G	1,550 – 3,000	120	top + bottom	yes	3062/3081	AK 301	14	–	21	20

ECE test report no.

Overrun device: 361-0043-97

ECE type approval no.

Drawbar installation: E1 55R-01 0466

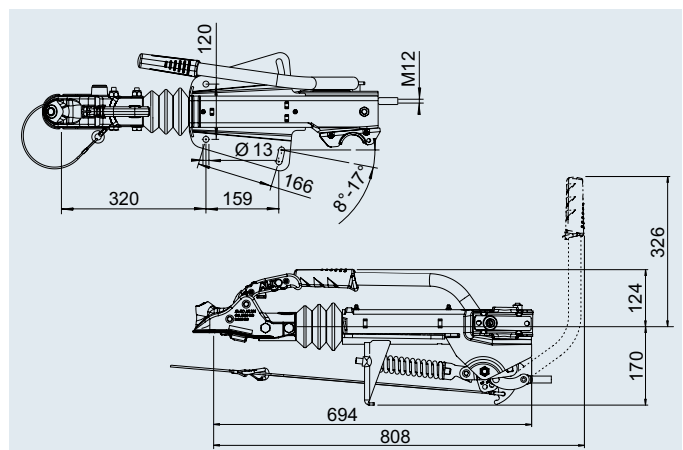
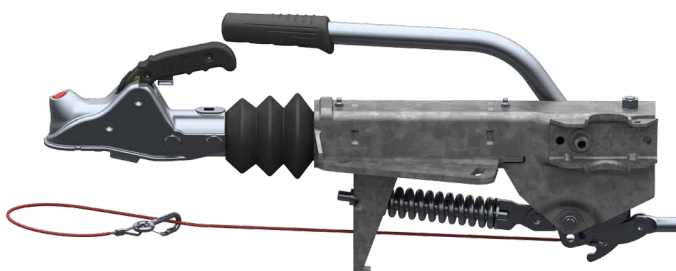

OVERRUN DEVICE V





1,550 to 3,000 kg



SAP: AE KPL V 251G TOTP AK301

Available starting August 2018

AE V 251G dead centre HBH with AK 301, with elevated jockey wheel flange

Order no.	Type	Total weight in kg	Support load in kg	Installation	Changeover relay lever?	Can be used with AL-KO wheel brake	Hitch mounted				
1 731 729	251 G	1,550 – 3,000	120	top + bottom	Yes	1637/2051	AK 301	19	–	19	2
1 731 730	251 G	1,550 – 3,000	120	top + bottom	Yes	2361	AK 301	19	–	19	20
1 731 731	251 G	1,550 – 3,000	120	top + bottom	Yes	3062/3081	AK 301	19	–	19	20

ECE test report no.

Overrun device: 361-0043-97

ECE type approval no.

Drawbar installation: E1 55R-01 0466

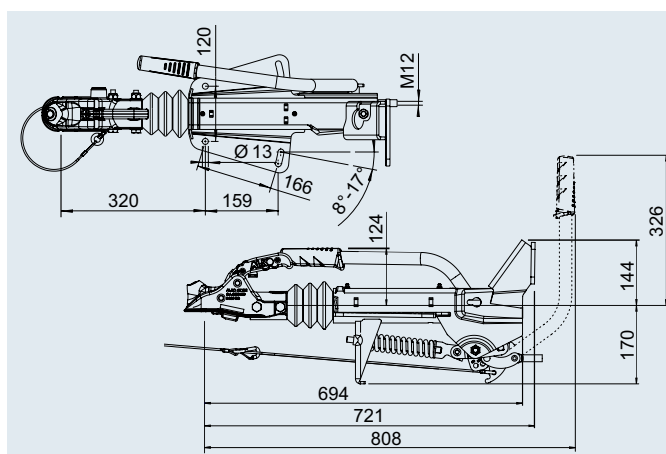
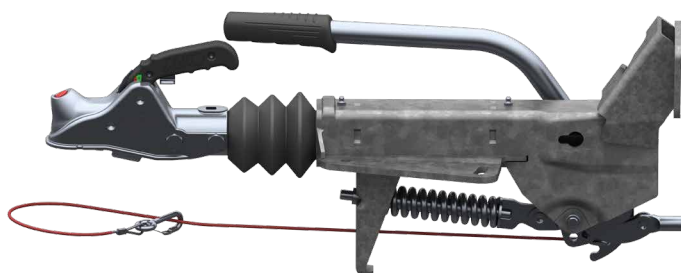

ALOIS KOBER GMBH

Ichenhauser Straße 14
89359 Kötz
Germany
Phone: +49 8221 97-0
info@alko-tech.com
www.alko-tech.com



Visit AL-KO at
facebook.com/alko.professional

Order no. 499 717 | Edition EN 04/2018
Subject to changes in response to technical progress.
No liability accepted for mistakes and printing errors.