

PremiumPartner
von Volkswagen Nutzfahrzeuge

AL-KO
QUALITY FOR LIFE

VOLKSWAGEN TRANSPORTER AL-KO CHASSIS TECHNOLOGY



AL-KO VEHICLE TECHNOLOGY

QUALITY FOR LIFE

FROM THE VILLAGE FORGE TO A GLOBAL CORPORATION

Our roots were planted in a small village smithy. The fact that a global corporation has emerged from these humble roots is also because we are constantly aware of what our identity represents and what values the company has always embodied: Quality, innovation in product and process as well as reliability and sustainability in our internal and external customer relations. That is the basis of our pursuit for sustainable growth and market leadership in our business divisions.

Since 2016 we have made our contribution to the DexKo Group, the world's leading manufacturers of axles and chassis components in the lightweight segment. We are proud to continue in successfully shaping this development together with the DexKo and to convey our brand promise of quality, safety and comfort for our products and services to the world.



LIFE FOR QUALITY

We love quality. We live quality. And we have the right answer for virtually all transport requirements in our sector. AL-KO Vehicle Technology is safety and quality in one: from the product to delivery. We want our customers to be satisfied and successful. **Quality for life!**



FOR WHEN THE BEST IS EXPECTED

Founded in 1931, AL-KO Vehicle Technology is now a global technology company with around 30 sites in Europe, South America, Asia and Australia. Offering high-quality chassis components for trailers, leisure vehicles and light commercial vehicles, AL-KO stands for optimum ergonomics and functionality, highest comfort as well as innovations for greater driving safety.

Every year AL-KO manufactures a five-digit number of innovative automotive chassis in five works worldwide. The largest production facility is the works in Ettenbeuren in the south of Germany.



RESEARCH AND DEVELOPMENT

Research and development are firmly involved in the product creation process from the initial idea right through to production. The result: Innovative solutions that satisfy the most demanding requirements. In close coordination and collaboration with the state-of-the-art Testing Department, our engineers at the new Technology Centre push individual components, assemblies, and even finished products to the limit every day.

We are proud of our customized, state-of-the-art testing facilities that enable the most stringent service life and wear tests in real application conditions. In our market environment, they offer unique opportunities for the testing of individual components and entire vehicles. Only what is assessed as flawless finally receives our „Quality for Life“ award!





AL-KO CHASSIS-TECHNOLOGY

With the AL-KO CHASSIS, we set standards in the van class. This applies for high frame chassis, but also for low frame chassis that enable low loading sills and low total vehicle heights. This has a positive effect on the fuel consumption and driving characteristics. A highlight is the 3-axle low-floor chassis with 13" tyres, consistent loading area as well as standard disc brakes and torsion guide rear axles.

FLEET OPTIMISATION

Why operate six vehicles when five perform the same transport capacity? We are the specialists for new innovative and intelligent solutions for optimising fleets. The basis is formed by our variable lightweight CHASSIS construction in a 2- or 3-axle variant with wide track chassis and independent suspension. This is the basis for additional load capacity, greater load volumes, more ergonomics – and much higher cost effectiveness.

Use the QR-Code or our internet adress for further information about Total Cost of Ownership:

www.alko-tech.com/en/save-fleet-costs



AL-KO CHASSIS TECHNIK

MORE PAYLOAD

Thanks to the intelligent light weight technology.

LONG SERVICE LIFE

Hot dip galvanised connection flanges and chassis components ensure maximum, reliable corrosion protection.

TRAILING ARM AXLE TORSION BAR SUSPENSION

The individual suspension offers car-like suspension comfort and optimal safety in conjunction with specially customised spring rods and high-performance wheel shock absorbers.

EASY TO SERVICE

Bolted frame parts are easy to service, ensuring shorter periods of downtime for repairs.



PremiumPartner
von Volkswagen Nutzfahrzeuge



WIDE TRACK CHASSIS

The maintenance-free rear axle with a wide axle gauge optimises the driving behaviour and provides the best possible driving safety and outstanding driving comfort.

MORE TRANSPORT VOLUME

Variable wheelbases in conjunction with the offered overhang variants make a customised solution possible for nearly all transport problems with optimal load distribution and the best driving stability. In addition, the wider rear gauge offers you more flexibility and approx. 100 mm more through-loading width.

ESP

For the AL-KO CHASSIS based on the Volkswagen Transporter, ESP (electronic stability program) with braking assist, ABS, ASR, EDS and hill climb assist come standard (with Premium Partner clearance certificate from Volkswagen Commercial Vehicles).

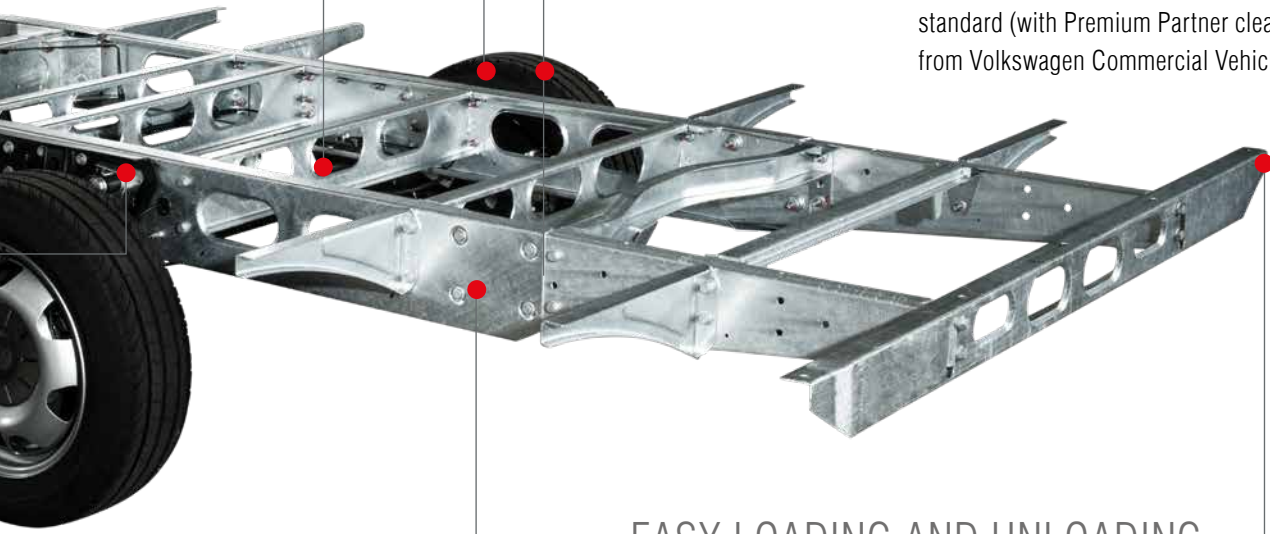

EASY LOADING AND UNLOADING

For easy and comfortable vehicle loading and unloading, the attachment of a tail lift is possible in conjunction with a support frame.

BASIC VEHICLE

Volkswagen Transporter cab

PR No. (VW order code)

- | ZG6: Cab (front axle 1,710 kg, tyres 17")
- | SL 4: AL-KO hole pattern
- | 2XS: Volkswagen 17" rear tyres

Category 6 side indicator

Category 6 side indicators are required by law for vehicles with a total length of >6m.
 Order no. factory-mounted: 1671562

TECHNICAL DATA

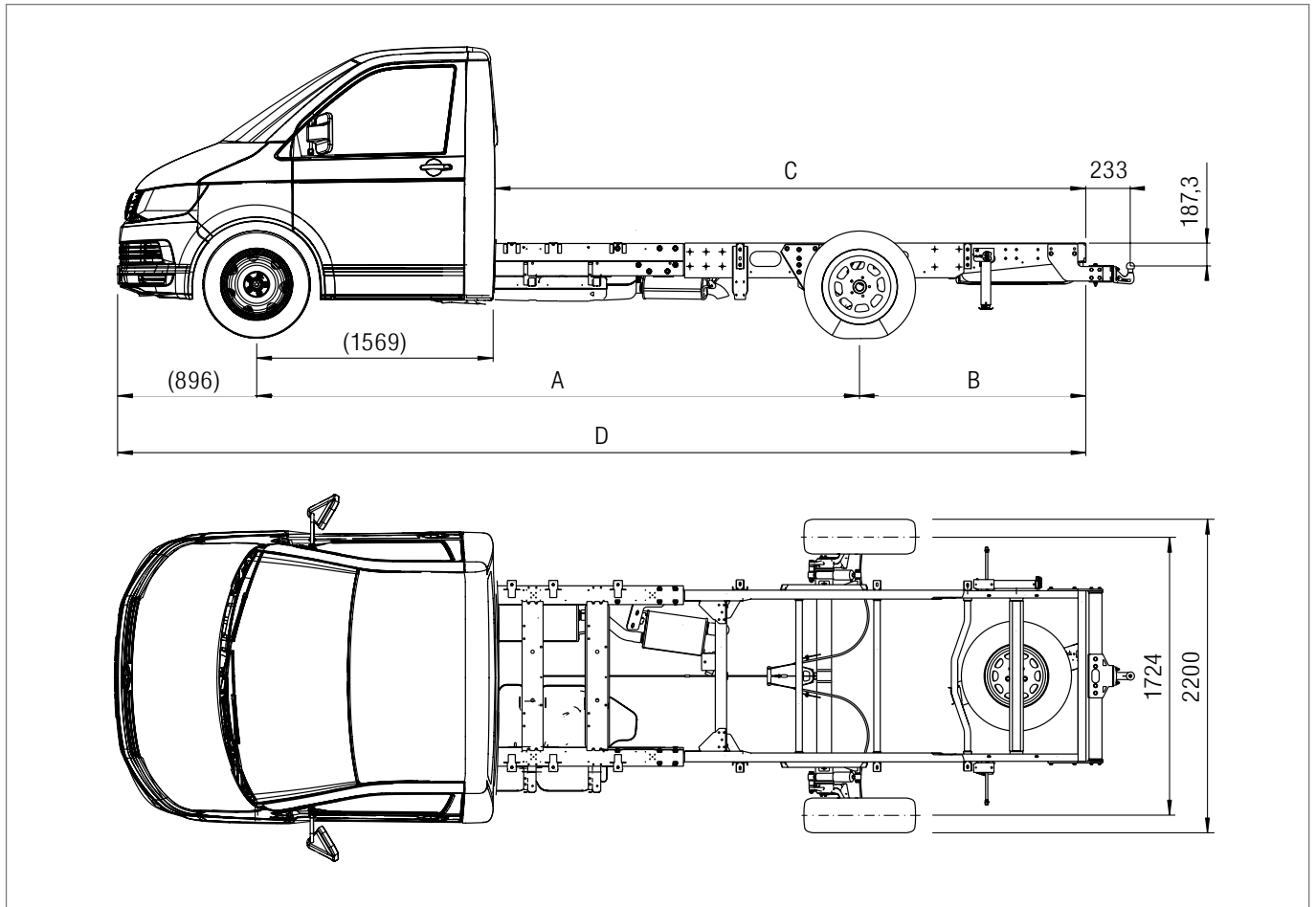

STANDARD DIMENSIONS¹⁾

A wheelbase	B overhang*	C frame length	D vehicle length
min. 3,580 mm - max. 4,600 mm	min. 990 mm - max. 2,150 mm	min. 3,001 mm - max. 4,896 mm	min. 5,466 mm - max. 7,658 mm

FRAME HEIGHT IN AXLE RANGE REAR

(Approx. values)

Tyre size	Frame height empty approx.	Frame height loaded approx.
215/60 R17 C	660 mm	580 mm

1) Other dimensions possible upon request and after technical coordination.

* Overhang dimension (B) max. 43% of wheelbase (A) permitted. Spare wheel holder option possible starting with overhang (B) 990 mm.

Technical data such as weights, axle loads and dimensions subject to change.

TYPE OVERVIEW, PERMISSIBLE WEIGHTS, AXLE AND TRAILER WEIGHTS

Type	Vehicle class	Engine version	Total permitted weight kg	Permitted front axle load kg	Permitted rear axle load kg	Permitted trailer weight kg	Permitted gross train weight ⁽⁴⁾ kg	Rear axle brake	Brake system
MC35T616	M1 ¹⁾ /N1	2.0 TDI (75 kW) ²⁾	3,500	1,710	1,900	2,000	4,900 (SG)	Disc	ABS ESP ⁵⁾
MC35T616	M1 ¹⁾ /N1	2.0 TDI (84 kW) ²⁾	3,500	1,710	1,900	2,000	4,900 (SG)	Disc	ABS ESP ⁵⁾
MC35T616	M1 ¹⁾ /N1	2.0 TDI (110 kW) ²⁾	3,500	1,710	1,900	2,000	5,200 (SG) 5,300 (AG)	Disc	ABS ESP ⁵⁾
MC35T617	M1 ¹⁾ /N1	2.0 TDI (150 kW) ²⁾	3,500	1,710	1,900	2,000	5,200 (SG) 5,300 (AG)	Disc	ABS ESP ⁵⁾

¹⁾ M1 with special purpose vehicles

²⁾ Emission standard Euro 6

³⁾ Comply with permitted gross train weight!

⁴⁾ SG = manual transmission /

AG = 7G-DSG automatic transmission

⁵⁾ The centre of gravity information for the complete vehicle when set-up with all equipment is required for activation of the ESP system. If the centre of gravity height is provided to AL-KO during ordering, then AL-KO will activate the appropriate ESP system. If the customer does not provide AL-KO with a binding centre of gravity height, then AL-KO will activate the ESP system ex works for a centre of gravity height of approx. >800 mm to approx. ≤950 mm. If the final, complete vehicle requires a different centre of gravity height, then the customer must activate the appropriate ESP system via a VW service partner.

WHEEL HOUSING DIMENSIONS

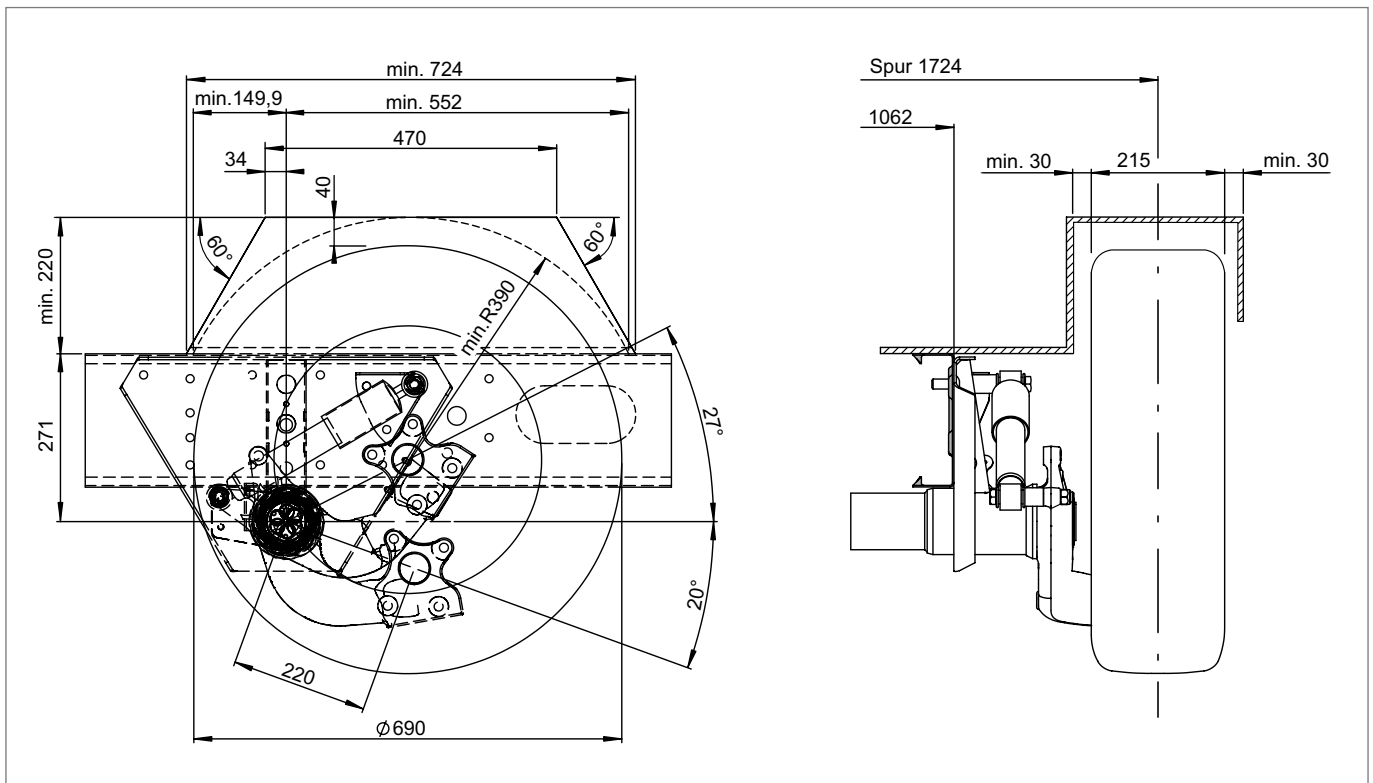

AL-KO CHASSIS

ACCESSORIES / SPECIAL EQUIPMENT

SPARE WHEEL / SPARE WHEEL HOLDER



- | Secure spare wheel attachment to the chassis rear
- | Problem-free retrofitting for most AL-KO CHASSIS with a straight rear structure.
- | Low assembly effort – easy assembly with standard on-board tool kits

MECHANICAL CLICKFIX SUPPORT JACK



- | Robust construction for firm and secure footing
- | Fast and convenient operation: just a half-turn of the crank and the prop stand is in the vertical support position
- | Dynamic load capacity 500 kg, static 1000 kg

TOWING HITCH



- | Customized exactly to the AL-KO CHASSIS
- | Offer the highest degree of safety
- | Only for AL-KO CHASSIS and/or AL-KO frame extensions
- | Low assembly effort
- | High-quality surface protection

LIGHT BRACKET



- | Available in black (other colours upon request)
- | Optional with position lights incl. holder (short/long)
- | Optional with LED lighting

SINGLE-WHEEL SUSPENSION



- Maintenance-free wide gauge rear axle with single-wheel, torsion bar, suspension as standard

AL-KO LANE DEPARTURE WARNING SYSTEM

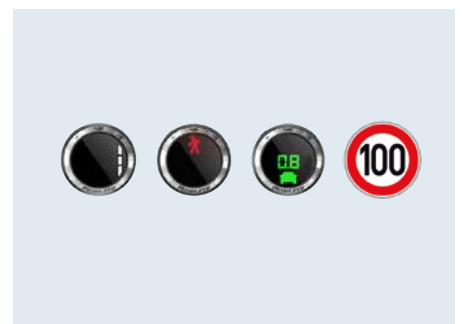

- | Lane departure warning
- | Passenger collision warning
- | Distance warning system
- | Traffic sign recognition

APPLICATION EXAMPLES



Box vehicle



Box vehicle



Box vehicle



Horse transporter



Refrigerated box vehicle

PremiumPartner
von Volkswagen Nutzfahrzeuge

AL-KO
QUALITY FOR LIFE

ALOIS KOBER GMBH

Ichenhauser Straße 14
89359 Kötz
Germany
Phone +49 8221 97-0
info@alko-tech.com
www.alko-tech.com

AL-KO Kober Limited

South Warwickshire Business Park
Kineton Road, Southam, Warwickshire, CV47 0AL
United Kingdom
Phone +44 1926 818 500
mail.uk@alko-tech.com
www.alko-tech.com/uk